

CSA, ULI

RIGID PVC CONDUIT FITTINGS - KRALOY

ISSUE DATE:  
DATE D'EMISSION: 2003 11 15

TYPE "E" ACCESS FITTINGS

SUPERCEDES:  
REPLACE: 2001 06 30

2

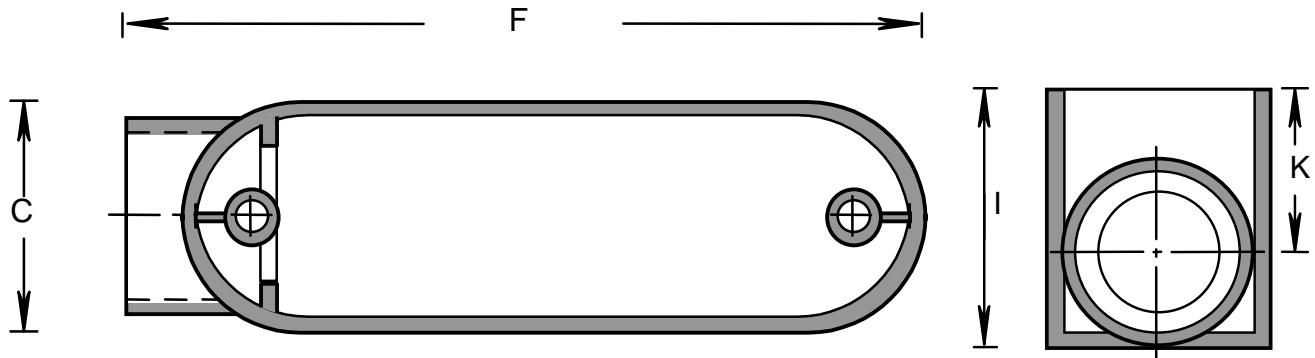

PRODUCT CODE	PART NUMBER	NOMINAL SIZE		C		F		I		K	
		(in)	(mm)	(in)	(mm)	(in)	(mm)	(in)	(mm)	(in)	(mm)
078128	E05	1/2	16	1.312	33	4.285	109	1.500	38	0.883	22
078129	E07	3/4	21	1.500	38	4.970	126	1.625	41	0.920	23
078130	E10	1	27	1.750	44	5.900	150	2.010	51	1.188	30
078131	E12	1 1/4	35	2.450	62	7.650	194	2.510	64	1.359	35
078132	E15	1 1/2	41	2.468	63	7.812	198	2.520	64	1.360	35
078133	E20	2	53	3.062	78	9.970	253	3.455	88	2.016	51
078134	E25	2 1/2	63	4.500	114	13.630	346	6.240	159	2.610	66
078135	E30	3	78	4.500	114	13.630	346	6.240	159	2.610	66
078136	E35	3 1/2	91	5.540	141	16.000	406	7.500	191	2.975	76
078137	E40	4	103	5.540	141	16.000	406	7.500	191	2.975	76

PRODUCT CODE	PART NUMBER	NOMINAL SIZE		FILL VOLUME		INSERT CODE	SCREW CODE	REDUCER CODE	COVER CODE	GASKET CODE
		(in)	(mm)	(cu.in)	(cu.cm)					
078128	E05	1/2	16	4.2	68.9		072563		093106	072421
078129	E07	3/4	21	7.6	124.6		072564		093107	072422
078130	E10	1	27	13.1	214.8		072564		093108	072735
078131	E12	1 1/4	35	26.6	436.2		072564		093109	072736
078132	E15	1 1/2	41	39.0	639.6		072564		093110	072736
078133	E20	2	53	70.9	1162.8		072412		093111	072738
078134	E25	2 1/2	63	181.5	2976.6	072549	072516	097558	097956	097961
078135	E30	3	78	178.2	2922.5	072549	072516		097956	097961
078136	E35	3 1/2	91	338.6	5553.0	072549	072516	097991	097958	097963
078137	E40	4	103	338.6	5553.0	072549	072516		097958	097963

CSA, ULI

RIGID PVC CONDUIT FITTINGS - KRALOY

TYPE "E" ACCESS FITTINGS

ISSUE DATE:

DATE D'EMISSION: 2003 11 15

SUPERCEDES:

REPLACE: 2001 06 30

2

**MAXIMUM WIRE FILL**

<b>1/2" + 3/4" + 1"</b> <b>(12 + 21 + 27)</b>		<b>1 1/4"</b> <b>(35)</b>	<b>1 1/2"</b> <b>(41)</b>	<b>2"</b> <b>(53)</b>	<b>2 1/2"</b> <b>(63)</b>	<b>3"</b> <b>(78)</b>	<b>3 1/2"</b> <b>(91)</b>	<b>4"</b> <b>(103)</b>
MAX. WIRE FILL #6 AWG CONDUCTORS OR SMALLER FOR1": PULLING COMPOUND REQUIRED FOR #4 AWG	<b>U</b>	5.440" (138.2)	6.060" (153.9)	7.530" (191.3)	10.200" (259.1)	10.200" (259.1)	10.200" (259.1)	10.200" (259.1)
	<b>M</b>	#2	#1 /0	#2 /0	#250	#250	#250	#250
	<b>D</b>	5.441" (138.2)	6.125" (155.6)	8.125" (206.4)	10.500" (266.7)	10.441" (265.2)	11.875" (301.6)	11.875" (301.6)

U UL514 INVESTIGATION OF CONDUIT BODIES FOR THREE CONDUCTOR INSTALLATION WITH NO INVESTIGATION

M MAXIMUM WIRE FILL MARKED ON CONDUIT BODY

D DISTANCE BETWEEN HUBS ON CONDUIT BODY

Filename: KRALOY-05.doc  
Directory: \\Bersrvbdc\bergen\QC MANUAL  
Template: C:\Documents and Settings\joelau\Application  
Data\Microsoft\Templates\Normal.dot  
Title: SOCKET DIMENSION  
Subject:  
Author: joe lau  
Keywords:  
Comments:  
Creation Date: 12/22/2000 9:07 AM  
Change Number: 11  
Last Saved On: 11/9/2003 2:31 PM  
Last Saved By: Joe Lau  
Total Editing Time: 14 Minutes  
Last Printed On: 8/8/2005 12:38 PM  
As of Last Complete Printing  
Number of Pages: 2  
Number of Words: 311 (approx.)  
Number of Characters: 1,779 (approx.)